



hmi

high-accuracy
measurement
instruments

FICHA TÉCNICA DE PRODUTO

PRODUCT DATASHEET

HMI – Automação e Instrumentação, Lda.

Travessa da Indústria, nº 111
4780-573 Santo Tirso
PORTUGAL

Tel. +351 252 850 501
Fax. +351 300 013 487

Web: www.hmi.pt

Email: hmi@hmi.pt

ABB MEASUREMENT & ANALYTICS | SPARE PARTS LIST

ProcessMaster FEP300, FEP500 HygienicMaster FEH300, FEH500 Electromagnetic flowmeter



Measurement made easy

ProcessMaster
FEP300, FEP500

HygienicMaster
FEH300, FEH500

Additional Information

Additional documentation on ProcessMaster FEP300, FEP500 HygienicMaster FEH300, FEH500 is available for download free of charge at www.abb.com/flow.

Alternatively simply scan this code:



Table of contents

1	Safety instructions for repair work.....	3
2	Name plate specifications for spare parts orders	4
	Name plate for model with integral mount design	4
	Name plate for model with remote mount design	4
	Name plate, transmitter	5
3	Transmitter housing, models FEP311, FEP511 (integral mount design).....	6
4	Terminal boxes FEP321, FEH321 (remote mount design)	8
5	Terminal boxes FEP521, FEH521 (remote mount design)	9
6	Upgrade Kits	10
	Upgrade from FXE4000 / FXM2000 to FET300 / FET500	10
7	External transmitters FET321, FET521	12
8	Transmitter plug-in module FET301.....	14
	Order numbers up to hardware index 00.xx.xx	14
	Order numbers as of hardware index 01.xx.xx.....	15
9	Transmitter plug-in module FET501.....	16
	Order numbers as of hardware index 01.xx.xx.....	16
10	Fuses for transmitter electronics.....	17
11	Upgrade kit for FEP300 / FEP500 series	17
12	Accessories	18
13	Seals for welded spuds series FEH300 / FEH500	19
	Flat gaskets (new in accordance with PED)	19
	O-ring gaskets (old).....	20
	External gasket	21
	Weld-in connector for wafer type devices	21
	Grounding plates.....	22

1 Safety instructions for repair work

ABB flowmeters are designed to be easy to repair thanks to uniform replacement parts and simple replacement of predefined parts.

However, if repair work is not carried out in accordance with the guidelines, this may result in malfunctioning of the device, causing serious injury to persons, and harm to the environment. This is especially true for safety-critical devices and those certified for use in explosion hazard environments.

Certifications will also lapse if the repairs were not carried out with the proper tool or by persons without adequate training. We therefore recommend all repair work on flowmeters be carried out by ABB service technicians.

As the manufacturer of the device, ABB cannot guarantee the necessary quality of the repair procedures if the work and/or parts exchange was not carried out by ABB.

The plant operator is responsible for all repairs carried out by the customer, plant operator, or third party. In this case, ABB will reject all responsibility for any improper device functionality, in particular all safety-related functions.

ABB does not assume any liability for the deterioration or loss of device performance, malfunctions, or damage arising from the above repair work or replacement. All liability for defects shall lapse when the replacement or repair work is not carried out by ABB.

If you are unsure about the repair process even if some or all replacement parts are available, please get in touch with ABB Service before beginning work.

Respect national and internal laws when carrying out repairs. In particular laws relating to certified flowmeters used in explosion hazard environments. Repair work which is carried out without following the legal requirements can result in the revocation of your operating permit.

For more information, go to <http://new.abb.com/service/repairs> or contact your local ABB Customer Service Center.

2 Name plate specifications for spare parts orders

The flowmeter version can be identified by referring to the name plate that is attached to the housing.

Name plate for model with integral mount design

When placing spare parts orders, always remember to state the order number as shown on the name plate.

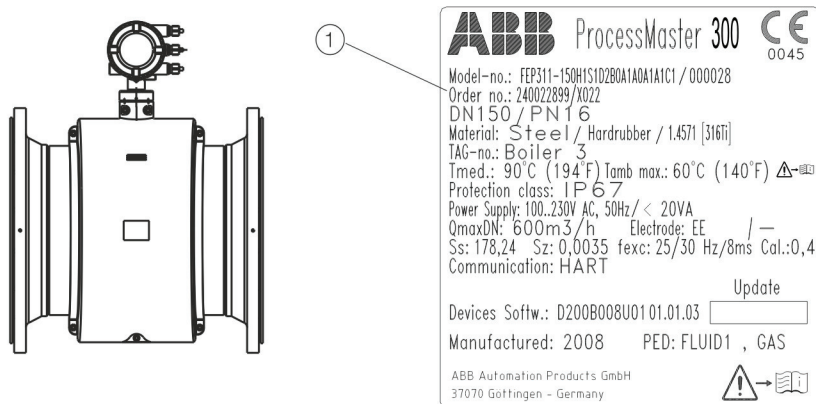

① Order number

Figure 1: Name plate for model with integral mount design

Name plate for model with remote mount design

When placing spare parts orders, always remember to state the order number as shown on the name plate.

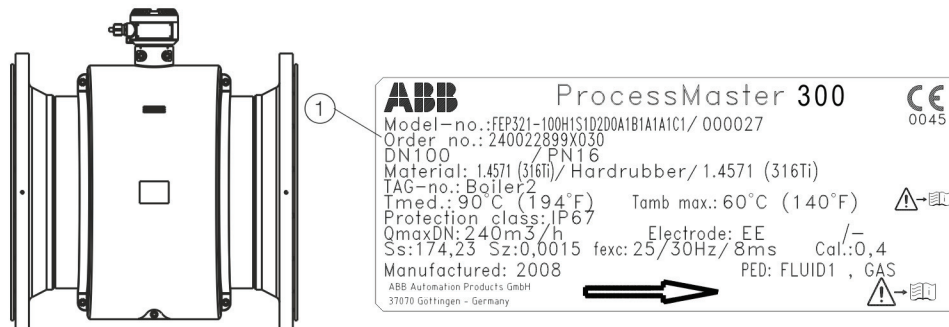

① Order number

Figure 2: Name plate for model with remote mount design

Name plate, transmitter

When placing spare parts orders, always remember to state the order number as shown on the name plate.

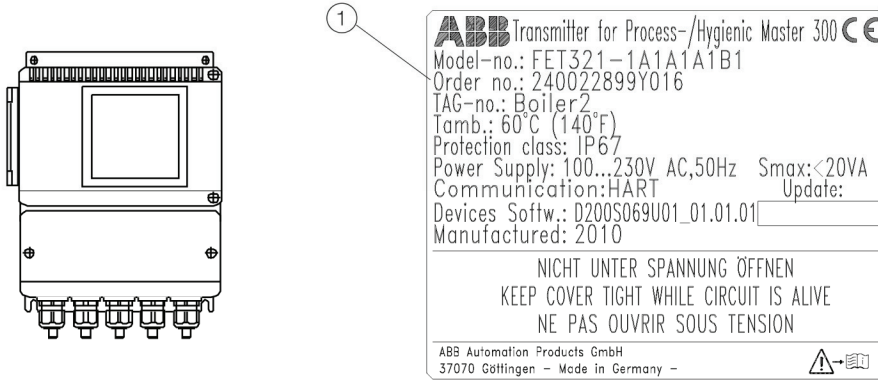

① Order number

Figure 3: Transmitter name plate

3 Transmitter housing, models FEP311, FEP511 (integral mount design)

Note

Prices available upon request!

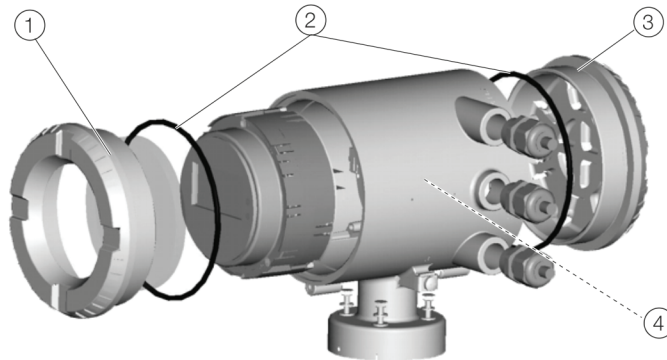

Figure 4: Dual-compartment housing

Number	Designation	FEP311	FEP511	Recommended spare Price (€)
		Ordering number	Ordering number	
① – ④	Housing complete, preassembled, standard, M20x1.5	D800D515U01	D800D518U01	
	Housing complete preassembled, standard, NPT ½ in.	D800D515U02	D800D518U02	
	Housing complete, preassembled, stainless steel, M20x1.5	D800D518U04	D800D518U04	
	Housing complete preassembled, standard, NPT ½ in.	D800D518U05	D800D518U05	
① – ③	Housing cover set	D800D517U01	D800D517U01	x
④	Base plate, type 3, standard (covered)	D685A1156U01	D685A1156U01	
	Base plate, type 3, standard (covered) programmed	D685A1156U01A	D685A1156U01A	x
①	Housing cover with window	D612A197U01	D612A197U01	
	Housing cover (stainless steel) with window	3KQZ407112U0100	3KQZ407112U0100	
③	Housing cover without window	D379D172U01	D379D172U01	
	Housing cover (stainless steel) without window	3KQZ407109U0100	3KQZ407109U0100	
②	O-ring 118 x 1.7	D101A034U05	D101A034U05	x
-	Name plate (the order and serial numbers must both be stated)	D614L865U03	D614L865U03	

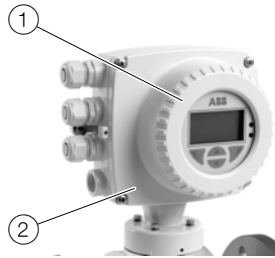

Figure 5: Single-compartment housing

Number	Designation	FEP311	FEP511	Recommended spare part	Price (€)
		Ordering number	Ordering number		
②	Housing+Backpl.INT M 20 Type4 FEPSL	3KXF002296U0100	3KXF002296U0100		
	Housing+Backpl.INT NPT Type4 FEP	3KXF002296U0200	3KXF002296U0200		
	SL Backplane Type4 FET/FEP FEP (covered)	3KXF002058U0100	3KXF002058U0100	x	
	SL Backplane Type4 FET/FEP (covered) programmed	3KXF002058U0100A	3KXF002058U0100A	x	
①	Cover with window VKJ Type4 Integral	3KXF002365U0100	3KXF002365U0100	x	
	O-Ring $\frac{5}{32}$ X.070 in. (concealed)	3KQP002016U0100	3KQP002016U0100	x	
-	Name plate (the order and serial numbers must both be stated)	3KXF002345U1100	3KXF002345U1100		

4 Terminal boxes FEP321, FEH321 (remote mount design)

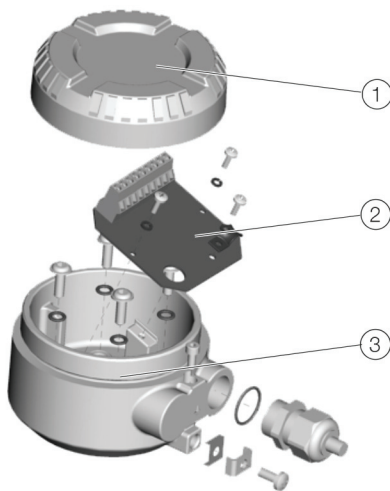

Figure 6: Terminal box

Number	Designation	Ordering number	Recommended spare part	Price (€)
① – ③	Terminal box complete, preassembled, standard, M20x1.5 (for model FEP321 only)	D800D516U01		
	Terminal box complete preassembled, standard, NPT ½ in. (for model FEP321 only)	D800D516U02		
	Terminal box complete, preassembled, stainless steel, M20x1.5 (for model FEH321 only)	D800D516U05		
①	Housing cover, standard (for model FEP321 only)	D379D174U01	X	
	Housing cover, stainless steel (for model FEH321 only)	D379D179U01	X	
②	Connection board, standard	D685A1090U02	X	
	Terminal board, standard programming	D685A1090U02A	X	
	Connection board with preamplifier	3KXF002601U0100	X	
	Terminal board with preamplifier, programmed	3KXF002601U0100A	X	
③	O-ring	D101A034U06	X	
-	Name plate (the order and serial numbers must both be stated)	D614L865U03		

5 Terminal boxes FEP521, FEH521 (remote mount design)

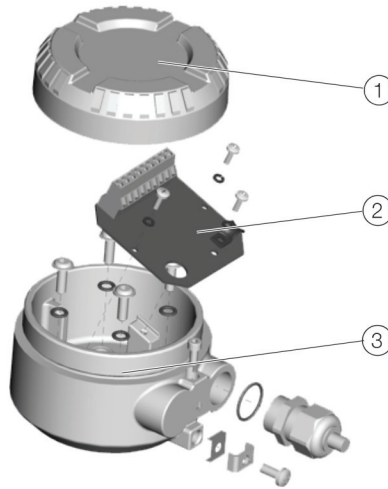

Figure 7: Terminal box

Number	Designation	Ordering number	Recommended spare part	Price (€)
① – ③	Terminal box complete, preassembled, standard, M20x1.5 (for model FEP521 only)	D800D519U01		
	Terminal box complete preassembled, standard, NPT ½ in. (for model FEP521 only)	D800D519U02		
	Terminal box complete, preassembled, stainless steel, M20x1.5 (for model FEH521 only)	D800D519U05		
①	Housing cover, standard (for model FEP321 only)	D379D174U01	X	
	Housing cover, stainless steel (for model FEH521 only)	D379D179U01	X	
②	Connection board, standard	D685A1090U02	X	
	Terminal board, standard programming	D685A1090U02A	X	
	Connection board with preamplifier	3KXF002601U0100	X	
	Terminal board with preamplifier, programmed	3KXF002601U0100A	X	
③	O-ring	D101A034U06	X	
-	Name plate (the order and serial numbers must both be stated)	D614L865U03		

6 Upgrade Kits

Upgrade from FXE4000 / FXM2000 to FET300 / FET500

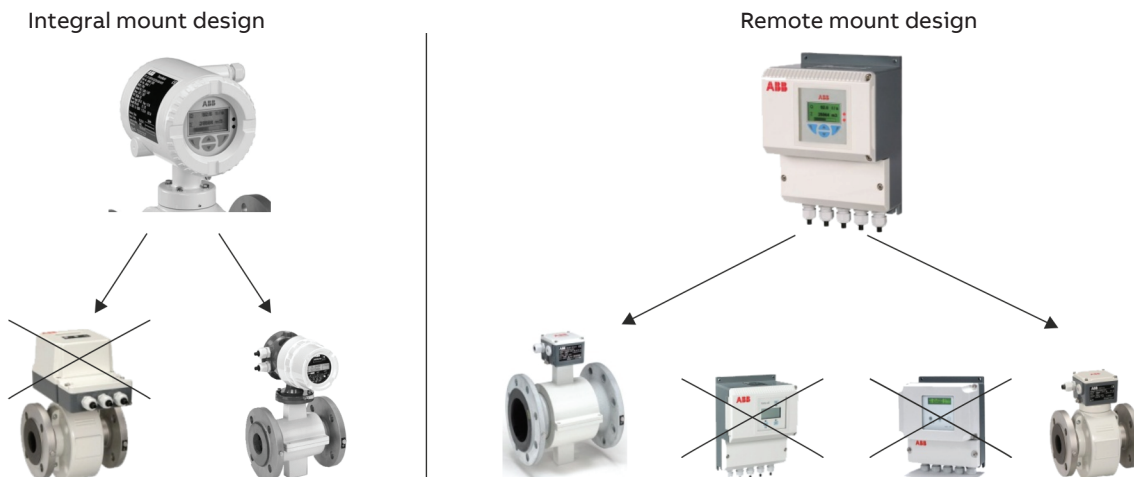

Figure 8: Upgrade Kits

Upgrade from FXE4000 to FET300

Number	Designation	Ordering number	Recommended spare Price (€) part
	Upgrade kit for FXE to FET300 Standard. 24 V	D800D311U01	
	Upgrade kit for FXE to FET300 PA 24 V	D800D311U02	
	Upgrade kit for FXE to FET300 FF 24 V	D800D311U03	
	Upgrade kit for FXE to FET300 Standard. 230 V	D800D311U04	
	Upgrade kit for FXE to FET300 PA 230 V	D800D311U05	
	Upgrade kit for FXE to FET300 FF 230 V	D800D311U06	
	Upgrade kit for remote FXE to FET300 Standard. 24 V	D800D321U01	
	Upgrade kit for remote FXE to FET300 PA 24 V	D800D321U02	
	Upgrade kit for remote FXE to FET300 FF 24 V	D800D321U03	
	Upgrade kit for remote FXE to FET300 Std. 230 V	D800D321U04	
	Upgrade kit for remote FXE to FET300 PA 230 V	D800D321U05	
	Upgrade kit for remote FXE to FET300 FF 230 V	D800D321U06	

Upgrade from FXM2000 to FET500

Number	Designation	Ordering number	Recommended spare Price (€) part
	Upgrade kit for FXM to FET500 Standard. 24 V	D800D511U01	
	Upgrade kit for FXM to FET500 PA 24 V	D800D511U02	
	Upgrade kit for FXM to FET500 FF 24 V	D800D511U03	
	Upgrade kit for FXM to FET500 Standard. 230 V	D800D511U04	
	Upgrade kit for FXM to FET500 PA 230 V	D800D511U05	
	Upgrade kit for FXM to FET500 FF 230 V	D800D511U06	
	Upgrade kit for remote FXM to FET500 Standard. 24 V	D800D521U01	
	Upgrade kit for remote FXM to FET500 PA 24 V	D800D521U02	
	Upgrade kit for remote FXM to FET500 FF 24 V	D800D521U03	
	Upgrade kit for remote FXM to FET500 Standard. 230 V	D800D521U04	
	Upgrade kit for remote FXM to FET500 PA 230 V	D800D521U05	
	Upgrade kit for remote FXM to FET500 FF 230 V	D800D521U06	

Note

Upgrades shall be at the user's own risk.

The upgrade kits contain the following components: terminal box, adapter plate, terminal board, and cartridge.

The upgrade can be performed by request on site or by the Göttingen service center.

7 External transmitters FET321, FET521

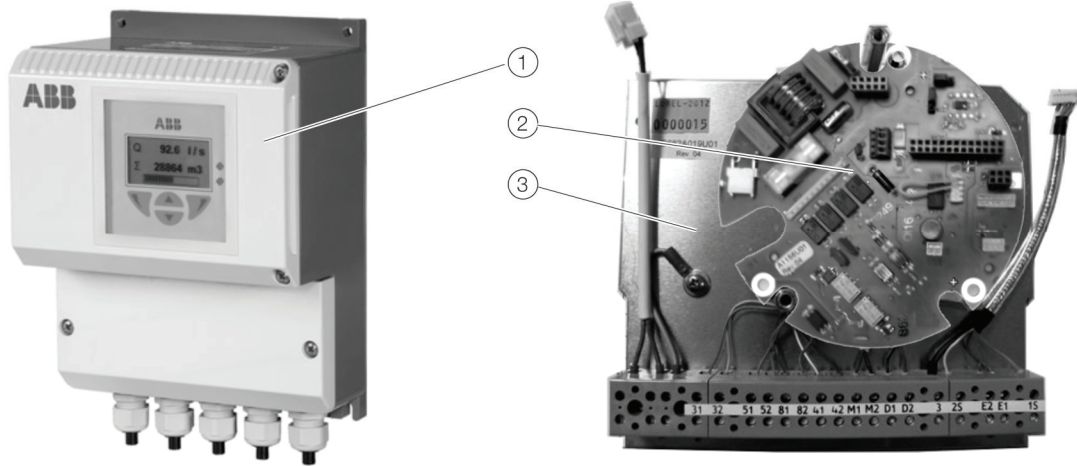

Figure 9: Remote transmitter

Number	Designation	Ordering number	Recommended spare Price (€) part
①	Field mount housing ABB EMF M20 x 1.5 incl. contact board (without transmitter plug-in unit)	D694A005U01	
	Field mount housing field bus M20 x 1.5 incl. contact board (without transmitter plug-in unit)	D694A003U02	
	Field mount housing field bus M20 x 1.5 without contact board (without transmitter plug-in unit)	D641A033U06	
②	Backplane Universal ABB EMF	D685A1156U01	X
③	Contact board for universal backplane	D682A019U01	X
	Contact board field bus	D682A016U02	X
-	Name plate for field-mount housing (the order and serial numbers must both be stated)	D338C788U01	



Figure 10: Single-compartment housing, terminal board

Number	Designation	Ordering number	Recommended spare Price (€) part
①	Single-compartment field mount housing ABB EMF M20x1.5 including contact board (excluding transmitter plug-in unit)	3KXF002295U0100	
	Type4 cover, painted, integral	MJBX9905	X
②	Backplane Universal ABB EMF	3KXF002058U0100	X
-	Name plate for field-mount housing (the order and serial numbers must both be stated)	D338C788U01	

8 Transmitter plug-in module FET301



Figure 11: Transmitter plug-in module

Order numbers up to hardware index 00.xx.xx

Number	Designation	Ordering number	Recommended spare part	Price (€)
	24 V plug-in module, HART standard ABB EMF	D674A905U01	X	
	24 V plug-in module, HART standard (replaces D674A880U01)	D674A905U01		
	24 V plug-in module, HART standard (replaces D674A880U01 and D674A899U01)	D674A905U01		
	230 V plug-in module, HART standard ABB EMF	D674A906U01	X	
	230 V plug-in module, HART standard (replaces D674A881U01)	D674A906U01		
	230 V plug-in module, HART standard (replaces D674A881U01 and D674A900U01)	D674A906U01		
	24 V replacement plug-in module, HART, standard	EXCD674A901U01		
	230 V replacement plug-in module, HART, standard	EXCD674A902U01		
	24 V replacement plug-in module, HART, standard	EXCD674A899U01		
	230 V replacement plug-in module, HART, standard	EXCD674A906U01		

Order numbers as of hardware index 01.xx.xx

Number	Designation	Ordering number	Recommended spare part	Price (€)
	24 V plug-in module, HART, standard	D674A905U01	X	
	Plug-in module 24 V, PROFIBUS PA, standard	D674A905U02	X	
	24 V plug-in module, FOUNDATION Fieldbus, standard	D674A905U03	X	
	230 V plug-in module, HART, standard	D674A906U01	X	
	Plug-in module 230 V, PROFIBUS PA, standard	D674A906U02	X	
	230 V plug-in module, FOUNDATION Fieldbus, standard	D674A906U03	X	
	24 V replacement plug-in module, HART, standard	EXCD674A905U01		
	24 V replacement plug-in module, PROFIBUS PA, standard	EXCD674A905U02		
	24 V replacement plug-in module, FOUNDATION Fieldbus, standard	EXCD674A905U03		
	230 V replacement plug-in module, HART, standard	EXCD674A906U01		
	230 V replacement plug-in module, PROFIBUS PA, Standard	EXCD674A906U02		
	230 V replacement plug-in module, FOUNDATION Fieldbus, standard	EXCD674A906U03		

9 Transmitter plug-in module FET501



Figure 12: Transmitter plug-in module

Order numbers as of hardware index 01.xx.xx

Number	Designation	Ordering number	Recommended spare part	Price (€)
	24 V plug-in module, HART, diagnostics	D674A903U01	X	
	24 V plug-in module, PROFIBUS PA, diagnostics	D674A903U02	X	
	24 V plug-in module, FOUNDATION Fieldbus, diagnostics	D674A903U03	X	
	230 V plug-in module, HART, diagnostics	D674A904U01	X	
	230 V plug-in module, PROFIBUS PA, diagnostics	D674A904U02	X	
	230 V plug-in module, FOUNDATION Fieldbus, diagnostics	D674A904U03	X	
	24 V replacement plug-in module, HART, diagnostics	EXCD674A903U01		
	24 V replacement plug-in module, PROFIBUS PA, diagnostics	EXCD674A903U02		
	24 V replacement plug-in module, FOUNDATION Fieldbus, diagnostics	EXCD674A903U03		
	230 V replacement plug-in module, HART, diagnostics	EXCD674A904U01		
	230 V replacement plug-in module, PROFIBUS PA, diagnostics	EXCD674A904U02		
	230 V replacement plug-in module, FOUNDATION Fieldbus, diagnostics	EXCD674A904U03		

10 Fuses for transmitter electronics

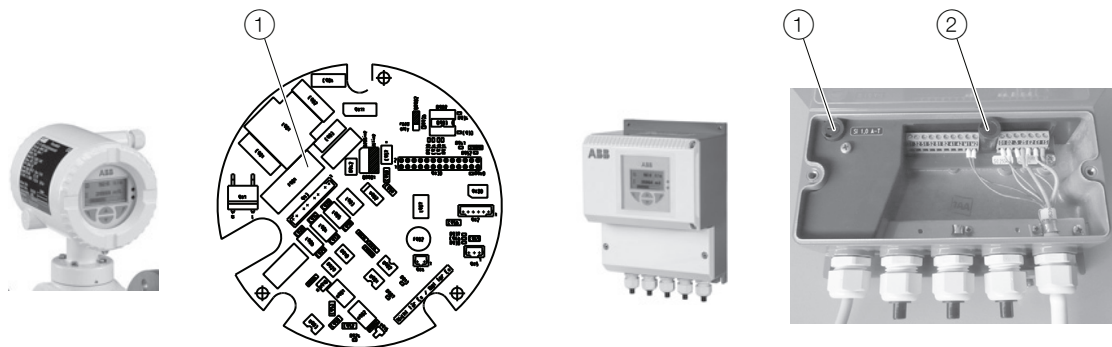

Figure 13: Transmitter electronic unit fuses

Number	Designation	Ordering number	Recommended spare Price (€) part
①	Power supply fuse (1.0 A)	D151B003U05	X
②	Coil circuit fuse (0.25 A) (only with devices featuring remote mount design)	D151B003U02	X

11 Upgrade kit for FEP300 / FEP500 series

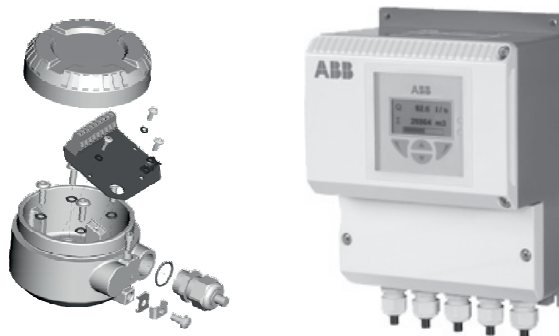





Figure 14: Upgrade kit FEP300 / FEP500 Series

Number	Designation	Ordering number	Recommended spare Price (€) part
	Upgrade kit with 10 m signal cable, integral mount design -> remote mount design, standard (for FEP300 only)	D800D514U02	
	Upgrade kit with 10 m signal cable, integral mount design -> remote mount design, with preamplifier (for FEP300 only)	D800D514U03	
	Upgrade kit with 10 m signal cable, integral mount design -> remote mount design, standard (for FEP500 only)	D800D514U04	
	Upgrade kit with 10 m signal cable, integral mount design -> remote mount design, with preamplifier (for FEP500 only)	D800D514U05	

12 Accessories

Number	Designation	Ordering number	Recommended spare part	Price (€)
	Infrared service port adapter FZA100 (USB, including software on CD-ROM)	D674A897U01		
				
	Diagnostics and verification software – ScanMaster FZC500 (on CD-ROM)	FZC500		
				
	ScanMaster FZC500 enabling license – 1 license	3KXS071500L0001		
	ScanMaster FZC500 enabling license – 3 licenses	Graduated prices		
	ScanMaster FZC500 enabling license – 5 licenses	available upon request.		
	ScanMaster FZC500 enabling license – 10 licenses			
	Adapter for flowmeter sensor simulator FXC4000	D674A898U01		
				
	Signal cable with braided shield (for IP68 IP rating), EX Zone 1, up to DN15	D173D027U01		
	Signal cable with foil shield (for IP68 IP rating)	D173D031U01		
	Display	D685A1129U01_K		
	PU potting compound	D141B038U01		

13 Seals for welded spuds series FEH300 / FEH500

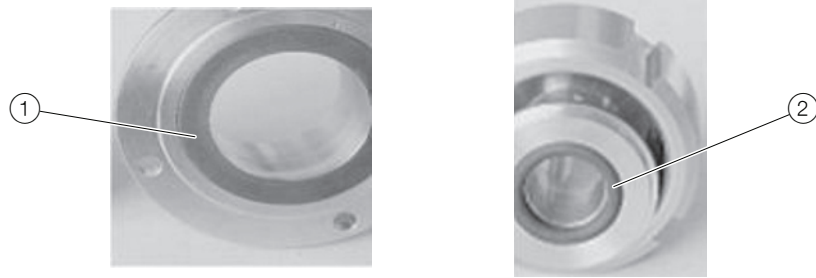

Figure 15: Gaskets

Flat gaskets (new in accordance with PED)

Number	Designation	Nominal diameter	Ordering number	Recommended spare part	Price (€)
①	Flat gasket EPDM FDA approval	DN 3 to 10	D333B007U11		
	Flat gasket silicone	DN 3 to 10	D333B007U12		
	Flat gasket EPDM FDA 70 Shore-A	DN 15	D333B008U11		
	Flat gasket silicone	DN 15	D333B008U12		
	Flat gasket EPDM FDA 70 Shore-A	DN 20	D333B009U11		
	Flat gasket silicone	DN 20	D333B009U12		
	Flat gasket EPDM FDA 70 Shore-A	DN 25	D333B010U11		
	Flat gasket silicone	DN 25	D333B010U12		
	Flat gasket EPDM FDA 70 Shore-A	DN 32	D333B011U11		
	Flat gasket silicone	DN 32	D333B011U12		
	Flat gasket EPDM FDA 70 Shore-A	DN 40	D333B012U11		
	Flat gasket silicone	DN 40	D333B012U12		
	Flat gasket EPDM FDA 70 Shore-A	DN 50	D333B013U11		
	Flat gasket silicone	DN 50	D333B013U12		
	Flat gasket EPDM FDA 70 Shore-A	DN 65	D333B014U11		
	Flat gasket silicone	DN 65	D333B014U12		
	Flat gasket EPDM FDA 70 Shore-A	DN 80	D333B015U11		
	Flat gasket silicone	DN 80	D333B015U12		
	Flat gasket EPDM FDA 70 Shore-A	DN 100	D333B016U11		
	Flat gasket silicone	DN 100	D333B016U12		

... 13 Seals for welded spuds series FEH300 / FEH500

O-ring gaskets (old)

Number	Designation	Nominal diameter	Ordering number	Recommended spare part	Price (€)
②	O-ring 21 x 3 Aeth-Prop. Shore-A 70		D101F001U01		
	O-ring 29 x 3 Aeth-Prop. Shore-A 70		D101F002U01		
	O-ring 33 x 3 Aeth-Prop. Shore-A 70		D101F003U01		
	O-ring 10.77 x 2.62 EPDM (FDA approval)		D101F006U01		
	O-ring 11.25 x 4.05 EPDM (FDA approval) 70-Shore-A	DN 3 to 10	D101F007U01		
	O-ring 14 x 4 EPDM (FDA approval) 70-Shore-A	DN 15	D101F008U01		
	O-ring 19 x 4 EPDM (FDA approval) 70-Shore-A	DN 20	D101F009U01		
	O-ring 25 x 5 EPDM (FDA approval) 70-Shore-A	DN 25	D101F010U01		
	O-ring 31 x 5 EPDM (FDA approval) 70-Shore-A	DN 32	D101F011U01		
	O-ring 37 x 5 EPDM (FDA approval) 70-Shore-A	DN 40	D101F012U01		
	O-ring 48 x 5 EPDM (FDA approval) 70-Shore-A	DN 50	D101F013U01		
	O-ring 63 x 5 EPDM (FDA approval) 70-Shore-A	DN 65	D101F014U01		
	O-ring 75 x 5 EPDM (FDA approval) 70-Shore-A	DN 80	D101F015U01		
	O-ring 97 x 5 EPDM (FDA approval) 70-Shore-A	DN 100	D101F016U01		
	O-ring 17.17 x 1.78 EPDM Shore A-70		D101F042U01		
	O-ring 28.24 x 2.62 EPDM Shore A-70		D101F043U01		
	O-ring 59.92 x 3.53 EPDM Shore A-70		D101F044U01		



Figure 16: External gaskets (example)

External gasket

Number	Designation	Nominal diameter	Ordering number	Recommended spare part	Price (€)
②	O-RING for DN 50		D101A035U01		
	O-RING for DN 65		D101A035U02		
	O-RING for DN 80		D101A035U03		
	O-RING for DN 100		D101A035U04		



Figure 17: Weld-in adaptor (example)

Weld-in connector for wafer type devices

Number	Designation	Nominal diameter	Ordering number	Recommended spare part	Price (€)
	FX / FE / FSM weld-in adapter	DN 3 to 10 ($\frac{1}{10}$ to $\frac{3}{8}$ in.)	D413C470U01		
	FX / FE / FSM weld-in adapter	DN 15 ($\frac{1}{2}$ in.)	D413C471U01		
	FX / FE / FSM weld-in adapter	DN 20 ($\frac{3}{4}$ in.)	D413C472U01		
	FX / FE / FSM weld-in adapter	DN 25 (1 in.)	D413C473U01		
	FX / FE / FSM weld-in adapter	DN 32 ($1\frac{1}{4}$ in.)	D413C474U01		
	FX / FE / FSM weld-in adapter	DN 40 ($1\frac{1}{2}$ in.)	D413C475U01		
	FX / FE / FSM weld-in adapter	DN 50 (2 in.)	D413C488U03		
	FX / FE / FSM weld-in adapter, previous installation length	DN 65 ($2\frac{1}{2}$ in.)	D413C461U09		
	FX / FE / FSM weld-in adapter, new installation length	DN 65 ($2\frac{1}{2}$ in.)	D413C461U11		
	FX / FE / FSM weld-in adapter, previous installation length	DN 80 (3 in.)	D413C496U03		
	FX / FE / FSM weld-in adapter, new installation length	DN 80 (3 in.)	D413C496U05		
	FX / FE / FSM weld-in adapter, previous installation length	DN 100 (4 in.)	D413C498U03		
	FX / FE / FSM weld-in adapter, new installation length	DN 100 (4 in.)	D413C498U05		

... 13 Seals for welded spuds series FEH300 / FEH500

Grounding plates

Material / raw material: 1.4571

Number	Designation	Variant	Ordering number	Recommended spare Price (€) part
	GROUNDING PLATE 1.4571	DN 3 to 8, PN 10 to 40	D374A165U21	
	GROUNDING PLATE 1.4571	DN 10, PN 10 to 40	D374A165U22	
	GROUNDING PLATE 1.4571	DN 15, PN 10 to 40	D374A165U23	
	GROUNDING PLATE 1.4571	DN 20, PN 10 to 40	D374A165U24	
	GROUNDING PLATE 1.4571	DN 25, PN 10 to 40	D374A165U25	
	GROUNDING PLATE 1.4571	DN 32, PN 10 to 40	D374A165U26	
	GROUNDING PLATE 1.4571	DN 40 PN 10 to 40/300 lb	D374A165U27	
	GROUNDING PLATE 1.4571	DN 50 PN 10 to 40/300 lb	D374A165U28	
	GROUNDING PLATE 1.4571	DN 65, PN 10 to 40	D374A165U29	
	GROUNDING PLATE 1.4571	DN 80, PN 10 to 40	D374A165U30	
	GROUNDING PLATE 1.4571	DN 100, PN 10 to 16	D374A165U31	
	GROUNDING PLATE 1.4571	DN 125, PN 10 to 16	D374A165U32	
	GROUNDING PLATE 1.4571	DN 150, PN 10 to 16	D374A165U33	
	GROUNDING PLATE 1.4571	DN 200, PN 10 to 16	D374A165U34	
	GROUNDING PLATE 1.4571	DN 250, PN 10 to 16	D374A165U35	
	GROUNDING PLATE 1.4571	DN 300, PN 10	D374A165U39	
	GROUNDING PLATE 1.4571	DN 300, PN 16	D374A165U44	
	GROUNDING PLATE 1.4571	DN 350, PN 10	D374A165U40	
	GROUNDING PLATE 1.4571	DN 350, PN 16	D374A165U45	
	GROUNDING PLATE 1.4571	DN 400, PN 10	D374A165U41	
	GROUNDING PLATE 1.4571	DN 400, PN 16	D374A165U46	
	GROUNDING PLATE 1.4571	DN 500, PN 10	D374A165U42	
	GROUNDING PLATE 1.4571	DN 500, PN 16	D374A165U47	
	GROUNDING PLATE 1.4571	DN 600, PN 10	D374A165U43	
	GROUNDING PLATE 1.4571	DN 600, PN 16	D374A165U48	
	GROUNDING PLATE 1.4571	½ in. (DN 3 to 8) 150 lb	D374A165U58	
	GROUNDING PLATE 1.4571	½ in. (DN 10) 150 lb	D374A165U59	
	GROUNDING PLATE 1.4571	½ in. (DN 15) 150 lb	D374A165U60	
	GROUNDING PLATE 1.4571	DN 20, 150 lb	D374A165U61	
	GROUNDING PLATE 1.4571	1 in. (DN 25) 150 lb	D374A165U62	
	GROUNDING PLATE 1.4571	DN 32, 150 lb	D374A165U63	
	GROUNDING PLATE 1.4571	1 ½ in. (DN 40) 150 lb	D374A165U64	
	GROUNDING PLATE 1.4571	2 in. (DN 50) 150 lb	D374A165U65	
	GROUNDING PLATE 1.4571	DN 65, 150 lb	D374A165U66	

Material / raw material: 1.4571

Number	Designation	Variant	Ordering number	Recommended spare Price (€) part
	GROUNDING PLATE 1.4571	3 in. (DN80) 150 lb	D374A165U67	
	GROUNDING PLATE 1.4571	4 in. (DN100) 150 lb	D374A165U68	
	GROUNDING PLATE 1.4571	5 in.(DN125) 150 lb	D374A165U69	
	GROUNDING PLATE 1.4571	6 in. (DN150) 150 lb	D374A165U70	
	GROUNDING PLATE 1.4571	8 in. (DN200) 150 lb	D374A165U71	
	GROUNDING PLATE 1.4571	10 in. (DN250) 150 lb	D374A165U72	
	GROUNDING PLATE 1.4571	DN300 150 lb	D374A165U73	
	GROUNDING PLATE 1.4571	DN350 150 lb	D374A165U74	
	GROUNDING PLATE 1.4571	16 in. (DN400) 150 lb	D374A165U75	
	GROUNDING PLATE 1.4571	20 in. (DN500) 150 lb	D374A165U76	
	GROUNDING PLATE 1.4571	24 in. (DN600) 150 lb	D374A165U77	
	GROUNDING PLATE 1.4571	24 in. (DN600) 150 lb	D374A166U21	

... 13 Seals for welded spuds series FEH300 / FEH500

... Grounding plates

Material / raw material: HAST.C

Number	Designation	Variant	Ordering number	Recommended spare Price (€) part
	GROUNDING PLATE HAST. C	DN 10, PN 10 TO 40	D374A166U22	
	GROUNDING PLATE HAST. C	DN 15, PN 10 TO 40	D374A166U23	
	GROUNDING PLATE HAST. C	DN 20, PN 10 TO 40	D374A166U24	
	GROUNDING PLATE HAST. C	DN 25, PN 10 TO 40	D374A166U25	
	GROUNDING PLATE HAST. C	DN 32, PN 10 TO 40	D374A166U26	
	GROUNDING PLATE HAST. C	DN 40, PN 10 to 40, 300 lb	D374A166U27	
	GROUNDING PLATE HAST. C	DN 50, PN 10 TO 40, 300 lb	D374A166U28	
	GROUNDING PLATE HAST. C	DN 65, PN 10 to 40	D374A166U29	
	GROUNDING PLATE HAST. C	DN 80, PN 10 to 40	D374A166U30	
	GROUNDING PLATE HAST. C	DN 100, PN 10 to 16	D374A166U31	
	GROUNDING PLATE HAST. C	DN 125, PN 10 to 16	D374A166U32	
	GROUNDING PLATE HAST. C	DN 150, PN 10 to 16	D374A166U33	
	GROUNDING PLATE HAST. C	DN 200, PN 10 to 16	D374A166U34	
	GROUNDING PLATE HAST. C	DN 250, PN 10 to 16	D374A166U35	
	GROUNDING PLATE HAST. C	DN 300, PN 10	D374A166U39	
	GROUNDING PLATE HAST. C	DN 300, PN 16	D374A166U44	
	GROUNDING PLATE HAST. C	DN 350, PN 10	D374A166U40	
	GROUNDING PLATE HAST. C	DN 400, PN 10	D374A166U41	
	GROUNDING PLATE HAST. C	½ in. (DN3 to 8) 150 lb	D374A166U58	
	GROUNDING PLATE HAST. C	DN 10, 150 lb	D374A166U59	
	GROUNDING PLATE HAST. C	½ in. (DN15) 150 lb	D374A166U60	
	GROUNDING PLATE HAST. C	DN 20, 150 lb	D374A166U61	
	GROUNDING PLATE HAST. C	1 in. (DN25) 150 lb	D374A166U62	
	GROUNDING PLATE HAST. C	DN 32, 150 lb	D374A166U63	
	GROUNDING PLATE HAST. C	1 ½ in. (DN 40) 150 lb	D374A166U64	
	GROUNDING PLATE HAST. C	2 in. (DN 50) 150 lb	D374A166U65	
	GROUNDING PLATE HAST. C	2 ½ in. (DN 65) 150 lb	D374A166U66	
	GROUNDING PLATE HAST. C	3 in. (DN 80) 150 lb	D374A166U67	
	GROUNDING PLATE HAST. C	4 in. (DN 100) 150 lb	D374A166U68	
	GROUNDING PLATE HAST. C	DN 150, 150 lb	D374A166U70	
	GROUNDING PLATE HAST. C	DN 200, 150 lb	D374A166U71	
	GROUNDING PLATE HAST. C	DN 230, 150 lb	D374A166U72	
	GROUNDING PLATE HAST. C	DN 350, 150 lb	D374A166U74	
	GROUNDING PLATE HAST. C	DN 10, PN 10 TO 40	D374A166U22	

Material / raw material: titanium

Number	Designation	Variant	Ordering number	Recommended spare Price (€) part
	GROUNDING PLATE titanium	DN 3 to DN 8 PN 10 to PN 40	D374A167U21	
	GROUNDING PLATE titanium	DN 10, PN10 to 40	D374A167U22	
	GROUNDING PLATE titanium	DN 15, PN10 to 40	D374A167U23	
	GROUNDING PLATE titanium	DN 20, PN10 to 40	D374A167U24	
	GROUNDING PLATE titanium	DN 25, PN10 to 40	D374A167U25	
	GROUNDING PLATE titanium	DN 32, PN10 to 40	D374A167U26	
	GROUNDING PLATE titanium	DN 40, PN 10 to 40, 300 lb	D374A167U27	
	GROUNDING PLATE titanium	DN 50, PN 10 to 40, 300 lb	D374A167U28	
	GROUNDING PLATE titanium	DN 65, PN10 to 40	D374A167U29	
	GROUNDING PLATE titanium	DN 80, PN10 to 40	D374A167U30	
	GROUNDING PLATE titanium	DN 100, PN 10 to 16	D374A167U31	
	GROUNDING PLATE titanium	½ in. (DN 3 to 8) 150 lb	D374A167U58	
	GROUNDING PLATE titanium	½ in. (DN 10) 150 lb	D374A167U59	
	GROUNDING PLATE titanium	½ in. (DN 15) 150 lb	D374A167U60	
	GROUNDING PLATE titanium	¾ in. (DN 20) 150 lb	D374A167U61	
	GROUNDING PLATE titanium	1 in. (DN 25) 150 lb	D374A167U62	
	GROUNDING PLATE titanium	DN 32, 150 lb	D374A167U63	
	GROUNDING PLATE titanium	1 ½ in. (DN 40) 150 lb	D374A167U64	
	GROUNDING PLATE titanium	2 in. (DN 50) 150 lb	D374A167U65	
	GROUNDING PLATE titanium	DN 65, 150 lb	D374A167U66	
	GROUNDING PLATE titanium	3 in. (DN 80) 150 lb	D374A167U67	
	GROUNDING PLATE titanium	4 in. (DN 100) 150 lb	D374A167U68	

Material / raw material: tantalum

Number	Designation	Variant	Ordering number	Recommended spare Price (€) part
	GROUNDING PLATE tantalum	DN 3 to DN 8	D374A268U01	
	GROUNDING PLATE tantalum	DN 15, PN to 40	D625A096U01	
	GROUNDING PLATE tantalum	DN 20, PN to 40	D625A096U04	
	GROUNDING PLATE tantalum	DN 25, PN to 40	D625A096U07	
	GROUNDING PLATE tantalum	DN 32, PN to 40	D625A096U10	
	GROUNDING PLATE tantalum	DN 40, PN40, 300 lb	D625A096U13	
	GROUNDING PLATE tantalum	DN 50, PN 40 / 300 lb	D625A096U16	
	GROUNDING PLATE tantalum	DN 15, 150 lb	D625A096U02	
	GROUNDING PLATE tantalum	DN 20, 150 lb	D625A096U05	
	GROUNDING PLATE tantalum	DN 25, 150 lb	D625A096U08	
	GROUNDING PLATE tantalum	DN 32, 150 lb	D625A096U11	
	GROUNDING PLATE tantalum	DN 40, 150 lb	D625A096U14	
	GROUNDING PLATE tantalum	DN 50, 150 lb	D625A096U17	

... 13 Seals for welded spuds series FEH300 / FEH500

... Grounding plates

Material / raw material: conductive PTFE

Number	Designation	Variant	Ordering number	Recommended spare Price (€) part
	Grounding plate from conductive PTFE	DN 10, PN 40	D377B106U01	
	Grounding plate from conductive PTFE	DN 15, PN 40	D377B106U02	
	Grounding plate from conductive PTFE	DN 20, PN 40	D377B106U03	
	Grounding plate from conductive PTFE	DN 25, PN 40	D377B106U04	
	Grounding plate from conductive PTFE	DN 32, PN 40	D377B106U05	
	Grounding plate from conductive PTFE	DN 40, PN 40	D377B106U06	
	Grounding plate from conductive PTFE	DN 50, PN 40	D377B106U07	
	Grounding plate from conductive PTFE	DN 65, PN 40	D377B106U09	
	Grounding plate from conductive PTFE	DN 80, PN 40	D377B106U10	
	Grounding plate from conductive PTFE	DN 100, PN 40	D377B106U11	
	Grounding plate from conductive PTFE	DN 125, PN 16	D374A258U01	
	Grounding plate from conductive PTFE	DN 150, PN 16	D374A239U01	
	Grounding plate from conductive PTFE	DN 200, PN 10 to 16	D374A259U01	
	Grounding plate from conductive PTFE	DN 10, 150 lb	D377B106U13	
	Grounding plate from conductive PTFE	DN 15, 150 lb	D377B106U14	
	Grounding plate from conductive PTFE	DN 20, 150 lb	D377B106U15	
	Grounding plate from conductive PTFE	DN 25, 150 lb	D377B106U16	
	Grounding plate from conductive PTFE	DN 32, 150 lb	D377B106U17	
	Grounding plate from conductive PTFE	DN 40, 150 lb	D377B106U18	
	Grounding plate from conductive PTFE	DN 50, 150 lb	D377B106U19	
	Grounding plate from conductive PTFE	DN 65, 150 lb	D377B106U20	
	Grounding plate from conductive PTFE	DN 80, 150 lb	D377B106U21	
	Grounding plate from conductive PTFE	DN 100, 150 lb	D377B106U22	
	Grounding plate from conductive PTFE	DN 50, PN 40	D377B106U23	
	Grounding plate from conductive PTFE	DN 150, 150 lb	D377B106U24	
	Grounding plate from conductive PTFE	DN 150, 150lb	D374A239U02	

Trademarks

HART is a registered trademark of FieldComm Group, Austin, Texas, USA

PROFIBUS and PROFIBUS DP are registered trademarks of PROFIBUS & PROFINET International (PI)

Hastelloy C is a trademark of Haynes International

ABB Automation GmbH
- Service Instruments -

Schillerstraße 72

D-32425 Minden

Deutschland

Fax: +49 571 830-1744

Mail: parts-repair-minden@de.abb.com

abb.com/flow

To find your local ABB branch, go to:

abb.com/contacts



We reserve the right to make technical changes or modify the contents of this document without prior notice. With regard to purchase orders, the agreed particulars shall prevail. ABB does not accept any responsibility whatsoever for potential errors or possible lack of information in this document.











We reserve all rights in this document and in the subject matter and illustrations contained therein. Any reproduction, disclosure to third parties or utilization of its contents – in whole or in parts – is forbidden without prior written consent of ABB.

Copyright© 2018 ABB
All rights reserved

3KXF231300R4701



Our offering:

	Actuators and Positioners		Analytical Instruments
	Device Management, Fieldbus and Wireless		Flow Measurement
	Force Measurement		Level Measurement
	Natural Gas Measurement		Pressure Measurement
	Recorders and Controllers		Temperature Measurement

HMI – Automação e Instrumentação, Lda.

Travessa da Indústria, nº 111
4780-573 Santo Tirso
PORTUGAL

Tel. +351 252 850 501
Fax. +351 300 013 487

Web: www.hmi.pt

Email: hmi@hmi.pt